

Students can connect with web resources and files from home or school using the [ClassLink Dashboard](#).

Getting Started

Step 1

Sign into Google Chrome.

Open the **Google Chrome browser** and sign in.

Signing into your Chrome browser allows you to save and sync bookmarks, history, passwords, and other settings to your @myplace account.

Cautions

- Only sign into Chrome on trusted devices.
- Don't sign into Chrome on a public or shared device.
- Be sure to lock your computer when you leave it.
- On a WCS owned device, only sign into Chrome using your @myplace.wcs.edu account.

1. Open the Chrome browser.

2. In the top right, select the "people" icon.

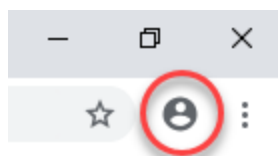

If you have previously signed in to your personal Gmail account, you may see your name instead.

3. Select **Sign in to Chrome**.

If you have previously signed into your personal Gmail account, select **Manage People** and **Add Person**.

4. Sign in with your full @myplace email address.

You may be prompted to do this twice.

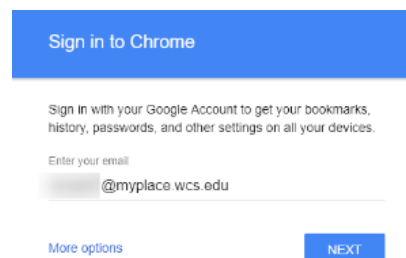

5. Sign in with your WCS username and password.

Login in using your WCS username and password

Sign in

Sign in with your WCS Account

Step 2

Access the ClassLink Dashboard at <https://my.classlink.com/wcstn>.

Step 3

Select *Sign in with ADFS*.

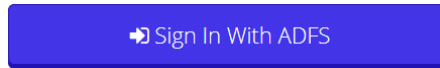

Step 4

Log in using your *WCS username and password*.

Login in using your WCS username and password

Sign in

Sign in with your WCS Account

Step 5

Click to open an app on your ClassLink Dashboard.



Updating Login Information

If needed, update the username and password for any apps that have the key icon in the corner.

Step 1

Right click on the app.



Step 2

Select **Update Password**.

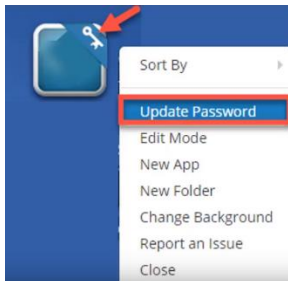

Step 3

Enter new or corrected **login information**.

Would you like to save your login?

 You can save your login for this application to auto-login on your next visit.

username

password

Step 4

Select **Save**.